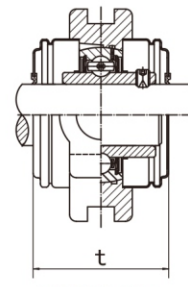
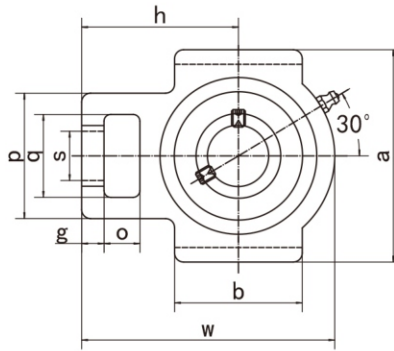
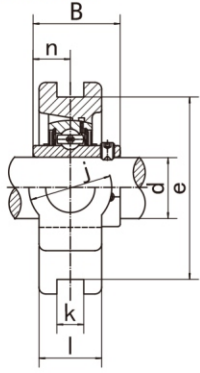

Take-up Units
UCT2 (Normal-duty)

 UCT-C₁(D₁)

Unit NO.	Dimensions (mm / in.)																	Bearing No.	Housing No.	Weight (kg)	
	d	o	g	p	q	s	b	k	e	a	w	j	l	h	t	B	n				
UCT201	12	16	10	51	32	19	51	12	76	89	94	32	21	61	44.5	31	12.7	UC201	T201	0.77	
201-8	1/2	5/8	25/64	2-1/64	1-1/4	3/4	2-1/64	15/32	2-63/64	3-1/2	3-11/16	1-1/4	53/64	2-13/32	1-3/4	1.2205	0.500			UC201-8	0.76
UCT202	15	16	10	51	32	19	51	12	76	89	94	32	21	61	44.5	31	12.7	UC202	T202	0.76	
202-9	9/16	5/8	25/64	2-1/64	1-1/4	3/4	2-1/64	15/32	2-63/64	3-1/2	3-11/16	1-1/4	53/64	2-13/32	1-3/4	1.2205	0.500			UC202-9	0.76
202-10	5/8	5/8	25/64	2-1/64	1-1/4	3/4	2-1/64	15/32	2-63/64	3-1/2	3-11/16	1-1/4	53/64	2-13/32	1-3/4	1.2205	0.500	UC202-10	0.76		
UCT203	17	16	10	51	32	19	51	12	76	89	94	32	21	61	44.5	31	12.7	UC203	T203	0.75	
203-11	11/16	5/8	25/64	2-1/64	1-1/4	3/4	2-1/64	15/32	2-63/64	3-1/2	3-11/16	1-1/4	53/64	2-13/32	1-3/4	1.2205	0.500			UC203-11	0.74
UCT204	20	16	10	51	32	19	51	12	76	89	94	32	21	61	44.5	31	12.7	UC204	T204	0.73	
204-12	3/4	5/8	25/64	2-1/64	1-1/4	3/4	2-1/64	15/32	2-63/64	3-1/2	3-11/16	1-1/4	53/64	2-13/32	1-3/4	1.2205	0.500			UC204-12	0.73
UCT205	25	16	10	51	32	19	51	12	76	89	97	32	24	62	48	34.1	14.3	UC205	T205	0.80	
205-13	13/16	5/8	25/64	2-1/64	1-1/4	3/4	2-1/64	15/32	2-63/64	3-1/2	3-13/16	1-1/4	15/16	2-7/16	1-7/8	1.3425	0.563			UC205-13	0.84
205-14	7/8	5/8	25/64	2-1/64	1-1/4	3/4	2-1/64	15/32	2-63/64	3-1/2	3-13/16	1-1/4	15/16	2-7/16	1-7/8	1.3425	0.563			UC205-14	0.83
205-15	15/16	5/8	25/64	2-1/64	1-1/4	3/4	2-1/64	15/32	2-63/64	3-1/2	3-13/16	1-1/4	15/16	2-7/16	1-7/8	1.3425	0.563			UC205-15	0.81
205-16	1	5/8	25/64	2-1/64	1-1/4	3/4	2-1/64	15/32	2-63/64	3-1/2	3-13/16	1-1/4	15/16	2-7/16	1-7/8	1.3425	0.563			UC205-16	0.80
UCT206	30	16	10	56	37	22	57	12	89	102	113	37	28	70	53	38.1	15.9	UC206	T206	1.22	
206-17	1-1/16	5/8	25/64	2-7/32	1-29/64	55/64	2-1/4	15/32	3-1/2	4-1/64	4-29/64	1-29/64	1-3/32	2-3/4	2-3/32	1.5000	0.626			UC206-17	1.23
206-18	1-1/8	5/8	25/64	2-7/32	1-29/64	55/64	2-1/4	15/32	3-1/2	4-1/64	4-29/64	1-29/64	1-3/32	2-3/4	2-3/32	1.5000	0.626			UC206-18	1.24
206-19	1-3/16	5/8	25/64	2-7/32	1-29/64	55/64	2-1/4	15/32	3-1/2	4-1/64	4-29/64	1-29/64	1-3/32	2-3/4	2-3/32	1.5000	0.626			UC206-19	1.22
206-20	1-1/4	5/8	25/64	2-7/32	1-29/64	55/64	2-1/4	15/32	3-1/2	4-1/64	4-29/64	1-29/64	1-3/32	2-3/4	2-3/32	1.5000	0.626			UC206-20	1.21
UCT207	35	16	13	64	37	22	64	12	89	102	129	37	30	78	59.5	42.9	17.5	UC207	T207	1.57	
207-20	1-1/4	5/8	33/64	2-33/64	1-29/64	55/64	2-33/64	15/32	3-1/2	4-1/64	5-5/64	1-29/64	1-3/16	3-5/64	2-11/32	1.6890	0.689			UC207-20	1.63
207-21	1-5/16	5/8	33/64	2-33/64	1-29/64	55/64	2-33/64	15/32	3-1/2	4-1/64	5-5/64	1-29/64	1-3/16	3-5/64	2-11/32	1.6890	0.689			UC207-21	1.60
207-22	1-3/8	5/8	33/64	2-33/64	1-29/64	55/64	2-33/64	15/32	3-1/2	4-1/64	5-5/64	1-29/64	1-3/16	3-5/64	2-11/32	1.6890	0.689			UC207-22	1.57
207-23	1-7/16	5/8	33/64	2-33/64	1-29/64	55/64	2-33/64	15/32	3-1/2	4-1/64	5-5/64	1-29/64	1-3/16	3-5/64	2-11/32	1.6890	0.689			UC207-23	1.54
UCT208	40	19	16	83	49	29	83	16	102	114	144	49	33	89	69	49.2	19	UC208	T208	2.31	
208-24	1-1/2	3/4	5/8	3-17/64	1-15/16	1-9/64	3-17/64	5/8	4-1/64	4-31/64	5-43/64	1-15/16	1-19/64	3-1/2	2-23/32	1.9370	0.748			UC208-24	2.35
208-25	1-9/16	3/4	5/8	3-17/64	1-15/16	1-9/64	3-17/64	5/8	4-1/64	4-31/64	5-43/64	1-15/16	1-19/64	3-1/2	2-23/32	1.9370	0.748			UC208-25	2.32
UCT209	45	19	16	83	49	29	83	16	102	117	144	49	35	87	69	49.2	19	UC209	T209	2.34	
209-26	1-5/8	3/4	5/8	3-17/64	1-15/16	1-9/64	3-17/64	5/8	4-1/64	4-39/64	5-43/64	1-15/16	1-3/8	3-27/64	2-23/32	1.9370	0.748			UC209-26	2.44
209-27	1-11/16	3/4	5/8	3-17/64	1-15/16	1-9/64	3-17/64	5/8	4-1/64	4-39/64	5-43/64	1-15/16	1-3/8	3-27/64	2-23/32	1.9370	0.748			UC209-27	2.40
209-28	1-3/4	3/4	5/8	3-17/64	1-15/16	1-9/64	3-17/64	5/8	4-1/64	4-39/64	5-43/64	1-15/16	1-3/8	3-27/64	2-23/32	1.9370	0.748			UC209-28	2.36
UCT210	50	19	16	83	49	29	86	16	102	117	149	49	37	90	74.5	51.6	19	UC210	T210	2.47	
210-29	1-13/16	3/4	5/8	3-17/64	1-15/16	1-9/64	3-17/64	5/8	4-1/64	4-39/64	5-55/64	1-15/16	1-29/64	3-35/64	2-15/16	2.0315	0.748			UC210-29	2.59
210-30	1-7/8	3/4	5/8	3-17/64	1-15/16	1-9/64	3-17/64	5/8	4-1/64	4-39/64	5-55/64	1-15/16	1-29/64	3-35/64	2-15/16	2.0315	0.748			UC210-30	2.54
210-31	1-15/16	3/4	5/8	3-17/64	1-15/16	1-9/64	3-17/64	5/8	4-1/64	4-39/64	5-55/64	1-15/16	1-29/64	3-35/64	2-15/16	2.0315	0.748			UC210-31	2.49
210-32	2	3/4	5/8	3-17/64	1-15/16	1-9/64	3-17/64	5/8	4-1/64	4-39/64	5-55/64	1-15/16	1-29/64	3-35/64	2-15/16	2.0315	0.748			UC210-32	2.45
UCT211	55	25	19	102	64	35	95	22	130	146	171	64	38	106	76	55.6	22.2	UC211	T211	3.74	
211-32	2	63/64	3/4	4-1/64	2-1/32	1-3/8	3-3/4	55/64	5-1/8	5-3/4	6-47/64	2-33/64	1-1/2	4-11/64	3	2.1890	0.874			UC211-32	3.89
211-33	2-1/16	63/64	3/4	4-1/64	2-1/32	1-3/8	3-3/4	55/64	5-1/8	5-3/4	6-47/64	2-33/64	1-1/2	4-11/64	3	2.1890	0.874			UC211-33	3.83
211-34	2-1/8	63/64	3/4	4-1/64	2-1/32	1-3/8	3-3/4	55/64	5-1/8	5-3/4	6-47/64	2-33/64	1-1/2	4-11/64	3	2.1890	0.874			UC211-34	3.79
211-35	2-3/16	63/64	3/4	4-1/64	2-1/32	1-3/8	3-3/4	55/64	5-1/8	5-3/4	6-47/64	2-33/64	1-1/2	4-11/64	3	2.1890	0.874			UC211-35	3.72
UCT212	60	32	19	102	64	35	102	22	130	146	194	64	42	119	89	65.1	25.4	UC212	T212	4.58	
212-36	2-1/4	1-17/64	3/4	4-1/64	2-1/32	1-3/8	4-1/64	55/64	5-1/8	5-3/4	7-41/64	2-33/64	1-21/32	4-11/16	3-1/2	2.5630	1.000			UC212-36	4.71
212-37	2-5/16	1-17/64	3/4	4-1/64	2-1/32	1-3/8	4-1/64	55/64	5-1/8	5-3/4	7-41/64	2-33/64	1-21/32	4-11/16	3-1/2	2.5630	1.000			UC212-37	4.63
212-38	2-3/8	1-17/64	3/4	4-1/64	2-1/32	1-3/8	4-1/64	55/64	5-1/8	5-3/4	7-41/64	2-33/64	1-21/32	4-11/16	3-1/2	2.5630	1.000			UC212-38	4.56
212-39	2-7/16	1-17/64	3/4	4-1/64	2-1/32	1-3/8	4-1/64	55/64	5-1/8	5-3/4	7-41/64	2-33/64	1-21/32	4-11/16	3-1/2	2.5630	1.000	UC212-39	4.49		
UCT213	65	32	21	111	70	41	121	26	151	167	224	70	44	137	89	65.1	25.4	UC213	T213	6.60	
213-40	2-1/2	1-17/64	53/64	4-3/8	2-3/4	1-39/64	4-49/64	1-1/32	5-15/16	6-37/64	8-13/16	2-3/4	1-23/32	5-25/64	3-1/2	2.5630	1.000			UC213-40	6.69
213-41	2-9/16	1-17/64	53/64	4-3/8	2-3/4	1-39/64	4-49/64	1-1/32	5-15/16	6-37/64	8-13/16	2-3/4	1-23/32	5-25/64	3-1/2	2.5630	1.000			UC213-41	6.60
UCT214	70	32	21	111	70	41	121	26	151	167	224	70	46	137	98	74.6	30.2	UC214	T214	6.74	
214-42	2-5/8	1-17/64	53/64	4-3/8	2-3/4	1-39/64	4-49/64	1-1/32	5-15/16	6-37/64	8-13/16	2-3/4	1-13/16	5-25/64	3-55/64	2.937	1.189			UC214-42	6.95
214-43	2-11/16	1-17/64	53/64	4-3/8	2-3/4	1-39/64	4-49/64	1-1/32	5-15/16	6-37/64	8-13/16	2-3/4	1-13/16	5-25/64	3-55/64	2.937	1.189			UC214-43	